



This product  
is designed for  
a sustainable  
future

# Permeable Holland Herringbone 8 cm

Designed exclusively for mechanical install, Permeable Holland Herringbone 8 cm with its unique spacer lugs, provides secure structural performance for permeable interlocking concrete pavements (PICP's). It works well under vehicular traffic.

It can be successfully mechanically installed by leaving each of the half pieces in each layer, or by replacing the half pieces with full pieces (as pictured). The pavement will function equally well in either method.

The flat, durable surface and low profile chamfer is well suited for pedestrian pavements. This shape and the narrow joints comply with the most recent requirements of the ADA (Americans with Disabilities Act) Guidelines. Use Permeable Holland Herringbone for:

- Driveways
- Parking Lots
- Commercial Applications
- Residences
- Pedestrian Plazas



## PRODUCT DATA\*

Unit	Stones / sq ft	Net Void	Pieces / Pallet	Coverage / Pallet	Weight / Unit	Weight / Pallet
Permeable Holland Herringbone Unit	4.75	8.4%	432	91.12 ft <sup>2</sup> (8.46 m <sup>2</sup> )	8 lbs (3.6 kg)	3,456 lbs (1,567 kg)

All **Weight per Pallet** noted above include a 50 lb pallet weight.

\* All metric dimensions are soft converted to Imperial.

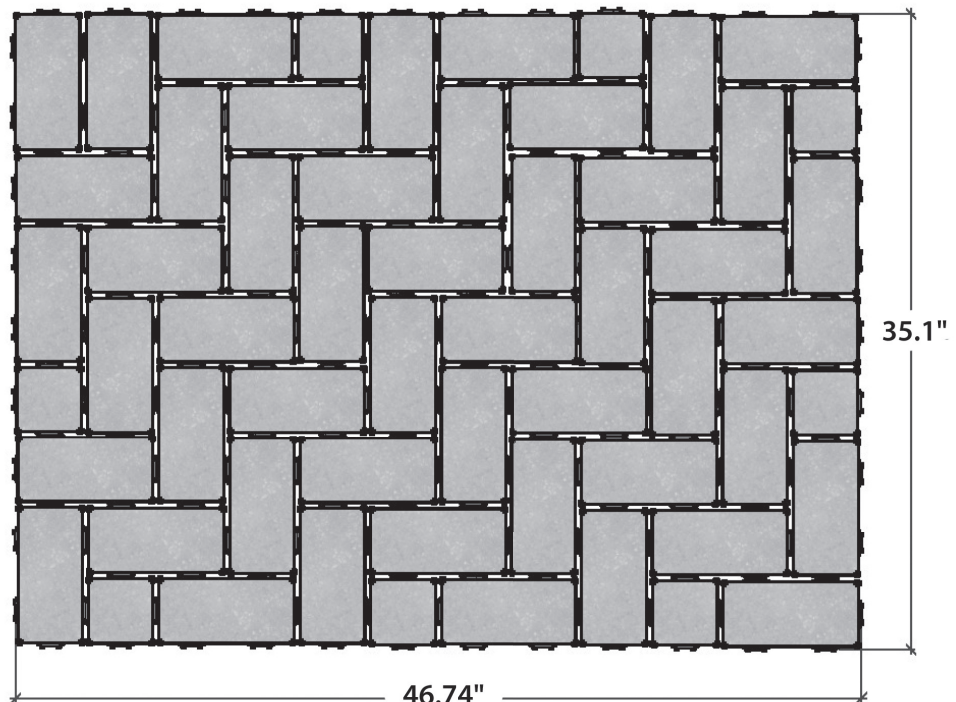

## STANDARD SPECIFICATION

Permeable Holland Herringbone 8 cm is manufactured to the same high quality specifications as all other Mutual Materials interlocking concrete pavers and meet or exceed the requirements in ASTM C 936, "Standard Specification for Solid Concrete Interlocking Paving Units."

### Permeable Holland Unit

4" x 8" x 3 1/8"  
100 mm x 200 mm x 80 mm

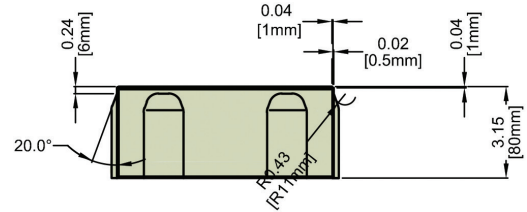
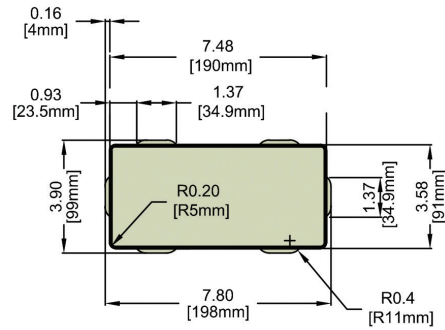

## PERMEABLE PAVEMENT DESIGN

For more specific and detailed instructions, please contact your Mutual Materials sales representative.

When building permeable pavement structures with Permeable 4 x 8, follow design and construction recommendations found in "Permeable Interlocking Concrete Pavements- 4th Edition" as published by the Interlocking Concrete Pavement Institute (ICPI, 2011). Copies are available from ICPI ([www.ICPI.org](http://www.ICPI.org)) or your Mutual Materials representative.

Also, LEED credits may be available for stormwater management, urban heat island reduction, and innovative design (according to the project certification process established by the USGBC).



**Green Note:** Permeable Holland Herringbone pavers may contribute towards LEED credits as determined by the USGBC. Credits vary by project and by manufacturer. For more specific information on how

Permeable Holland Herringbone might contribute towards LEED certification for your project, please contact your Mutual Materials sales representative.

## TYPICAL CROSS SECTION (FOR FULL EXFILTRATION DESIGNS)

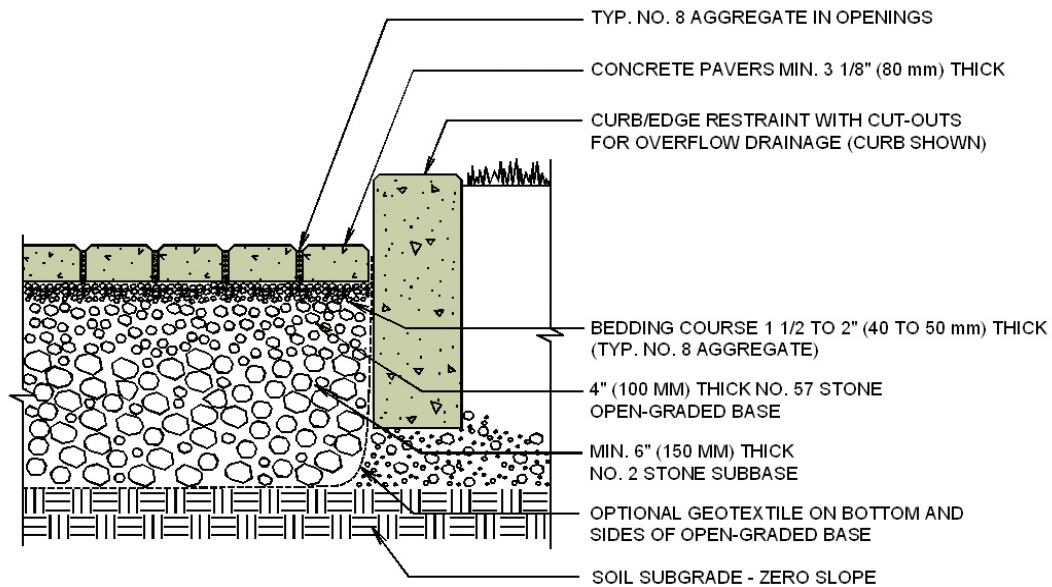

## MUTUAL MATERIALS LOCATIONS

For product information and customer service, call 1-888-MUTUALØ (688-8250).

### Washington

Auburn  
Bellevue  
Bellingham  
Mukilteo  
Olympia (Tumwater)

### Oregon

Bend  
Clackamas  
Durham  
Hillsboro  
Salem

### Idaho

Hayden

### Montana

Missoula



**MUTUAL MATERIALS®**  
Trusted Since 1900

[www.mutualmaterials.com](http://www.mutualmaterials.com)